

# Data sheet

## E-NF-H & E-NF-H-SM: Exterior non-fire & Smoke hinged doorset, single or pair

Our most popular non-fire hinged exterior door set, E-NF-H & E-NF-H-SM are available in singles or pairs. It has a solid laminated veneer lumber (LVL) core faced with marine grade plywood (P-CORE). The standard door leaf is supplied sealer coated on all six sides or you can specify a facing and/or kickplate. There is also an optional range of glazing formats or bespoke designs.

- Leaf sizes up to 2440 high x 1220 wide per leaf
- Thickness 44 mm
- Weight 20 kg /m<sup>2</sup>

### FACING OPTIONS

- Paint quality factory sealed
- 1 mm galvanised steel facings with aluminium edge capping
- 1 mm stainless steel kickplate to 1000 mm – interior side only
- Steel clad and capped

### LEAF EDGE DETAILS

- 7 mm hardwood clashing to hinge edge
- 7 mm hardwood clashing to leading edge of singles
- 18 mm hardwood clashing to leading edge of rebated pairs
- Steel Capping on steel clad leaves
- Aluminium capping on steel clad leaves, C&C, C&J, J&J

### PAIR MEETING STYLES

#### Timber (the standard option)

##### Flush

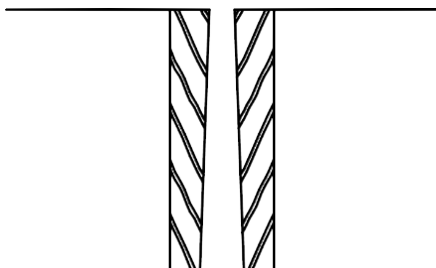

##### Rebated

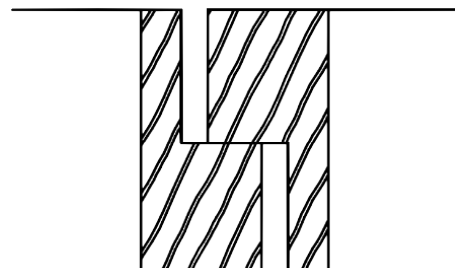

**Aluminium (Surcharge may apply)**

**C&C (Old Ecore)**

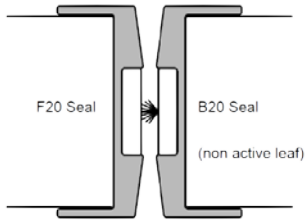

**C&J (Old Ecore)**

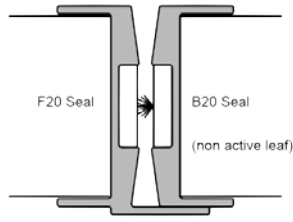

**J&J (Old Ecore)**

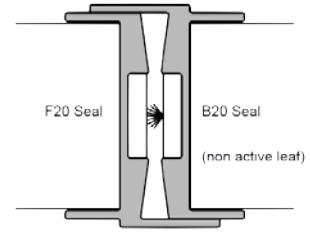

**C&C**

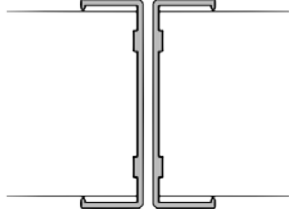

**C&J**

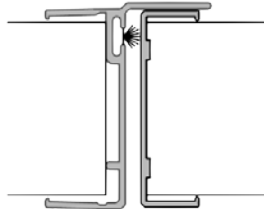

**J&J**

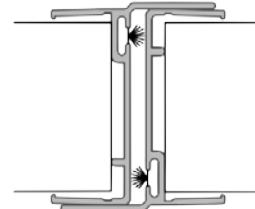

**GLAZING OPTIONS**

All options use 10.38 mm laminated glass. In addition to the standard options shown below, we offer bespoke designs that are available on request from our sales team. The maximum panel size is subject to minimum clearances.

**Placement Dimensions**

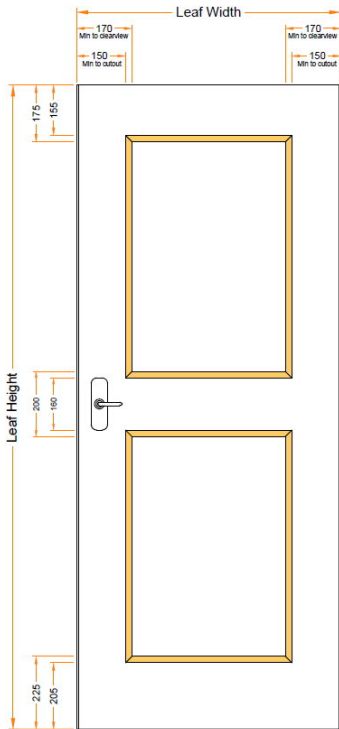

**Glass types & size limitations**

APPROVED GLASS & CLEARVIEW SIZES				
Rating	Glass	Max Height	Max Width	Max Area
NFR	10.38	2250	860	1.935 m <sup>2</sup>
-/30/-	Pyro 15	2250	860	1.935 m <sup>2</sup>
-/30/30	Pyro 15	2250	860	1.935 m <sup>2</sup>
-/60/-	Pyro 15	1830	610	0.92 m <sup>2</sup>
-/60/30	Pyro 15	1830	610	0.92 m <sup>2</sup>
-/60/60	Pyro 15	650	100	0.065 m <sup>2</sup>
-/60/60	Pyro 23	1700	300	0.51 m <sup>2</sup>
-/60/60	Pyro 23	450	450	0.2 m <sup>2</sup>
E-/60/30	Pyro 15	814	504	0.41 m <sup>2</sup>
-/240/30	Robax 6mm	600	100	0.06 m <sup>2</sup>
-/240/-	Robax 6mm	750	150	0.11 m <sup>2</sup>

**Some possible design idea's**

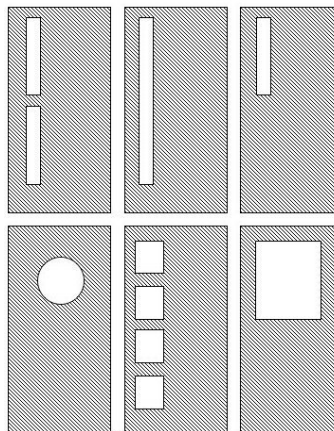

## GLAZING BEAD OPTIONS

### Bevel Bead with Lip (for weathering)

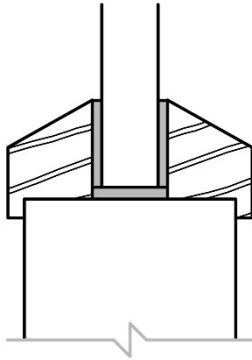

## JAMB TYPES AND PROFILES

32 mm hardwood timber (types 1, 2 & 3), width 81-350mm, planted stops (30x12), full width available at extra cost or 1.6 mm electrogalv steel (types 5, 6, 7 & Speedwall), paint quality or powdercoat options available

### T1 – Timber

*Timber flat for architrave*

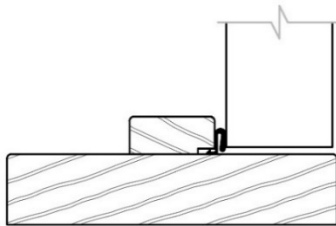

### T2 – Timber

*Groove for wall lining to suit (12mm reveals)*

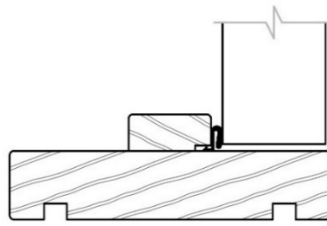

### T3 – Timber

*Rebate for wall lining to suit (non-standard surcharge may apply)*

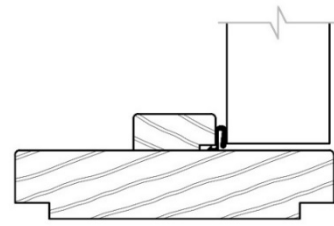

### T5 – Steel

*Steel width 106-350mm (based on 44mm thick leaf)*

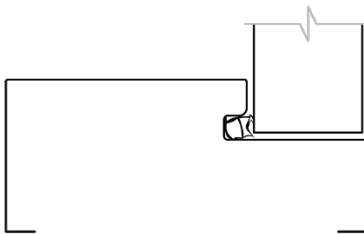

### T6 – Steel

*Steel width 141-203mm (based 44mm thick leaf)*

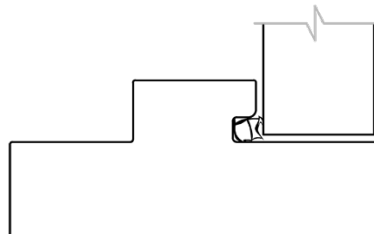

### Timber - Full width planted stop

*Timber – Full width planted stop  
Available for all timber profiles  
(non-standard surcharge applies)*

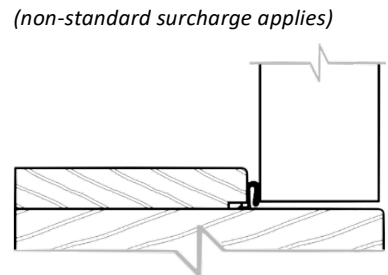

### T7 – two piece split steel

*Ideal for retrofit situations. No additional charge. Min 104mm if masonry wall, Min 112mm if stud wall – no max.*

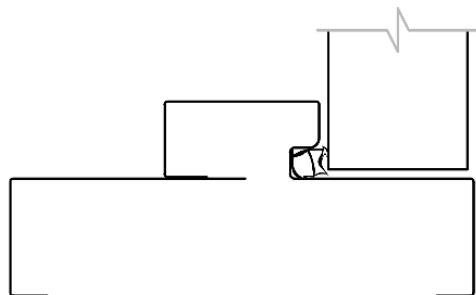

### Steel Speedwall

*Requires Speedwall C track*

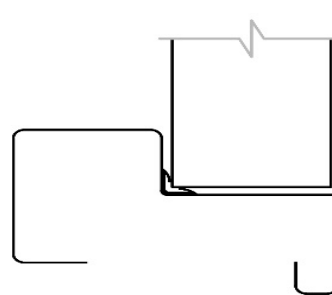

## **SIDELIGHTS AND OVERLIGHTS**

Not available for exterior door sets

## **APPROVED HARDWARE**

We can supply these doorsets with or without hardware. With pre-cropped doors the hardware supplied will be unfitted. Any standard hardware is suitable for these non-fire door sets.