

# Data sheet



## E-30-H: Exterior 30 minute FRR hung door, single

Our most popular 30 minute FRR hinged exterior fire, smoke and acoustic door set, the E-30-H is available in singles. The door leaf is a solid laminated veneer lumber (LVL) core faced with marine grade plywood (P-CORE). The standard door set is supplied sealer coated on all six sides or you can specify a facing and/or kickplate.

- Leaf sizes up to 2420 high x 1220 wide per leaf
- Thickness 44 mm
- Weight 20 kg /m<sup>2</sup>
- Acoustic singles and doubles STC 33

### FACING OPTIONS

- Paint quality factory sealed
- 1 mm stainless steel kickplate to 1000 mm – inside only

### LEAF EDGE DETAILS

- 7mm hardwood clashing hinge edge
- 7mm hardwood clashing to leading edge (flush pairs & singles)

## JAMB TYPES AND PROFILES

30 -32mm hardwood timber (types 1, 2 & 3), width 81-350mm, planted stops (30 x 12), full width available at extra cost (other timber options available by request)  
or 1.6 mm galv steel (types 5, 6, 7 & Speedwall), paint quality or powdercoat options available

### **T1 – Timber**

*Timber flat for architrave*

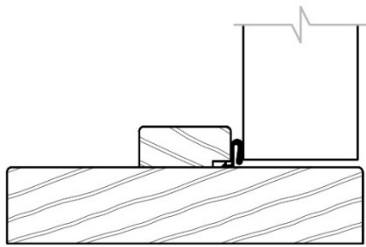

### **T2 – Timber**

*Groove for wall lining to suit  
(12mm reveals)*

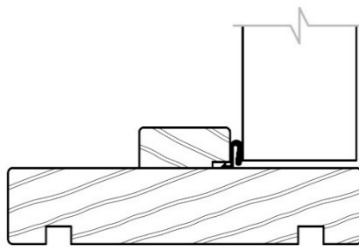

### **T3 – Timber**

*Rebate for wall lining to suit (non-  
standard surcharge may apply)*

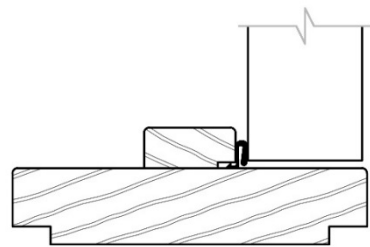

### **Timber- full width planted stop**

*Available for all timber profiles  
(non-standard surcharge applies)*

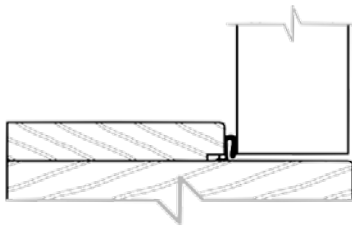

## **SIDELIGHTS AND OVERLIGHTS**

Not available for exterior door sets

## **APPROVED HARDWARE**

The minimum requirement is for a fire door to be self-closing and self-latching. Hardware must be selected from NZ Fire Doors' Approved Hardware list from the column '30 min'. Fitting any hardware that inhibits self-closing or self-latching is not approved by NZS 4520

**IMPORTANT:** Fitting untested or inappropriate hardware may affect the performance of the door and will void the warranty.