

Data sheet



E-60-H: Exterior 60 minute FRR hinged doorset, single

Our most popular 60 minute FRR hinged exterior fire, smoke and acoustic door set, the E-60-H is available in singles. The door leaf is a solid laminated veneer lumber (LVL) core faced with marine grade plywood (P-CORE). The standard door set is supplied sealer coated on both faces or you can specify a facing and/or kickplate.

- Leaf sizes up to 2420 high x 916 or 2134 x 1052
- Thickness 54 mm
- Weight 24 kg /m²
- Acoustic singles and doubles STC 34

FACING OPTIONS

- Paint quality factory sealed
- 1 mm stainless steel kickplate to 1000 mm – inside only

LEAF EDGE DETAILS

- 7mm hardwood clashing to hinge edge
- 7mm hardwood clashing to leading edge of (flush pairs & singles)

JAMB TYPES AND PROFILES

32 mm hardwood timber (types 1, 2 & 3)

or 1.6 mm electrogalv steel (types 5, 6, 7 & Speedwall), paint quality or powdercoat options available

T1 – Timber

Timber flat for architrave

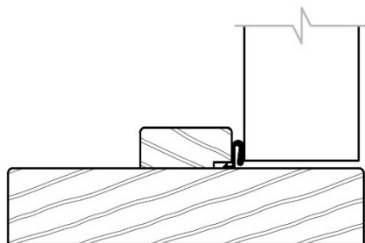

T2 – Timber

*Groove for wall lining to suit
(12mm reveals)*

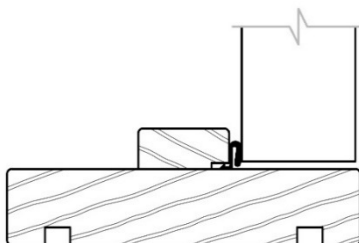

T3 – Timber

*Rebate for wall lining to suit (non-
standard surcharge may apply)*

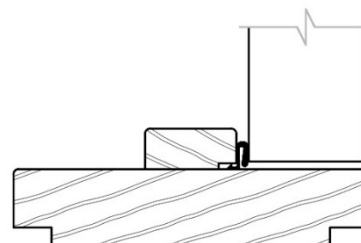

Timber – Full width planted stop

*Available for all timber profiles
(non-standard surcharge applies)*

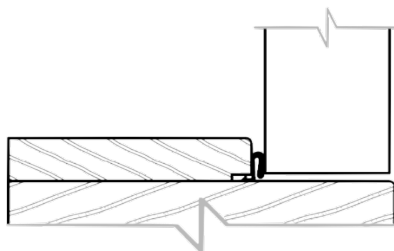

SIDELIGHTS AND OVERLIGHTS

Not available for exterior door sets

APPROVED HARDWARE

The minimum requirement is for a fire door to be self-closing and self-latching. Hardware must be selected from NZ Fire Doors' Approved Hardware list from the column '60 min'. Fitting any hardware that inhibits self-closing or self-latching is not approved by NZS 4520

IMPORTANT: Fitting untested or inappropriate hardware may affect the performance of the door and will void the warranty.