

# Data sheet

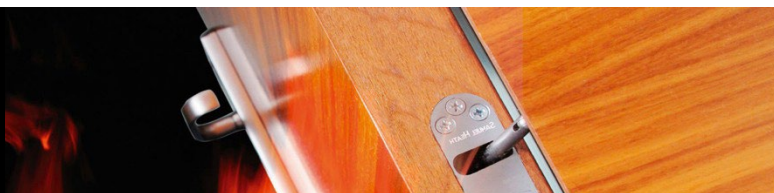

## I-30-D: Interior 30 minute FRR hung double acting door, single or pair

Our most popular 30 minute FRR double acting interior fire, smoke and acoustic door set, the I-30-D is available in singles or pairs. This door leaf is a solid composite timber core faced with an integral MDF layer (S-CORE). This doorset includes transom hardware, (floor springs are available please refer to NZFD). The standard door set is supplied sealer coated on both faces, as well as top and bottom, or you can specify a facing and/or kickplate.

- Leaf sizes up to 2200 high x 1200 wide per leaf (singles up to 2350 high x 1127 wide)
- Thickness 55 mm
- Weight 24.3 kg /m<sup>2</sup>
- Acoustic values are difficult to achieve with double acting doors as it is not possible to fit drop sill seals to the door bottoms

### FACING OPTIONS

- Paint quality factory sealed
- Timber veneer full height
- High pressure laminate full height
- Vinyl to 1000 mm
- 1 mm stainless steel kickplate to 1000 mm – both sides

### LEAF EDGE DETAILS

- NZFD bullnose (aluminium)

### PAIR MEETING STYLES

#### Aluminium

#### *Bullnose C/C*

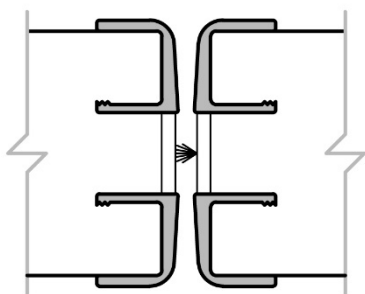

## JAMB TYPES AND PROFILES

30 – 32mm timber jambs, 60mm head standard (types 1, 2 & 3), min jamb width 115mm (other timber options available by request) or 1.6 mm electrogalv steel (type 8), paint quality or powdercoat options available

### ***T1 – Timber***

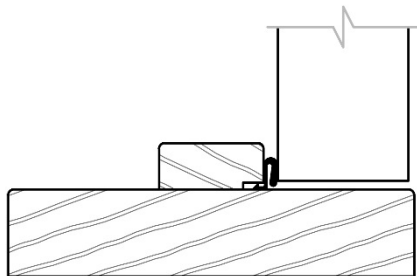

*Timber flat for architrave*

### ***T2 – Timber***

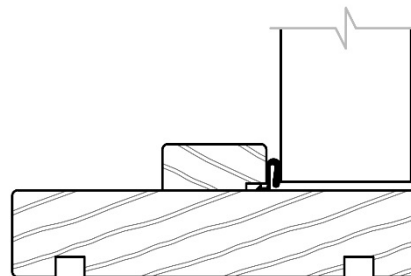

*Groove for wall lining to suit*

### ***T3 – Timber***

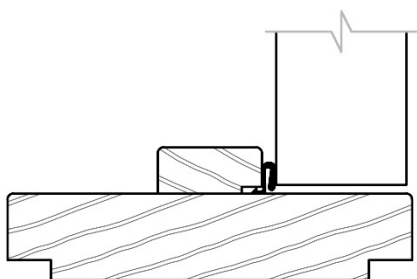

*Rebate for wall lining to suit (non-standard surcharge may apply)*

## APPROVED HARDWARE

The minimum requirement is for a fire door to be self-closing and self-latching. With our double acting doors the closers are the pivot mechanisms, which are already fitted. Hardware must be selected from NZ Fire Doors' Approved Hardware list from the column '30 min'. Fitting any hardware that inhibits self-closing or self-latching is not approved by NZS 4520

**IMPORTANT:** Fitting untested or inappropriate hardware may affect the performance of the door and will void the warranty.